

ORDERBOOK OVERVIEW

		Version	Update date
Table of contents		V 14	01-11-2024
Revision overview		V 14	01-11-2024
Factory options overview		V 07	01-05-2024
Product pages	All brands	-	01-11-2024
Annex	All brands	-	01-11-2024

ORDER INFORMATION FROM

Company	VB-Airsuspension B.V. Frankenweg 3, NL-7051 HV Varsseveld The Netherlands info@vbairsuspension.com www.vbairsuspension.com
Language	English
Currency	EUR - Euro
Symbol	€

DISCLAIMER

Prices	Prices provided are for information purposes only and are subject to change without notice. We reserve the right to adjust prices at any time. No rights can be derived from the prices provided, as they are a snapshot and only serve as an indication. Typesetting and printing errors are reserved.
Taxes	All prices stated are exclusive of GST/VAT, unless stated otherwise.
Assembly times	The installation times provided are guidelines only and are based on original standard vehicles ex-factory from the vehicle manufacturer. Deviations may occur based on individual vehicle specifications, adjustments or additional work. These times are estimates and may vary depending on several factors.

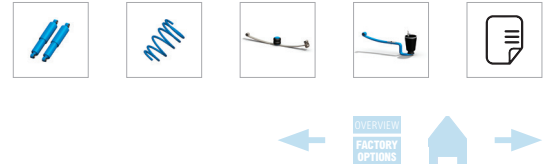

REVISION OVERVIEW | 01-11-2024

FACTORY OPTIONS OVERVIEW | 01-11-2024

CITROËN | JUMPY/SPACETOURER KO > 2017-CURRENT

- V 00 VB-CoilSpring
- V 01 VB-FullAir 2C - Rear axle

CITROËN | JUMPER X230/X244 > 1994-2006

- V 02 VB-CoilSpring
- V 02 VB-SemiAir

CITROËN AL-KO | JUMPER X230/X244 > 1994-2006

- V 02 VB-CoilSpring

CITROËN | JUMPER X250/X290 > 2006-CURRENT

- V 00 VB-SpecialParts
- V 00 VB-CoilSpring
- V 05 VB-SemiAir
- V 01 VB-FullAir 2C - Front axle
- V 02 VB-FullAir 2C - Rear axle
- V 00 VB-FullAir 2C - Modification set
- V 02 VB-FullAir 4C - Front and Rear axle
- V 02 VB-FullAir 2C - Extension kit

CITROËN AL-KO | JUMPER X250/X290 > 2006-CURRENT

- V 00 VB-SpecialParts
- V 00 VB-CoilSpring
- V 00 VB-SemiAir
- V 00 VB-FullAir 2C - Front axle
- V 00 VB-FullAir 2C - Rear axle - Single Axle
- V 00 VB-FullAir 2C - Rear axle - Twin Axle
- V 01 VB-FullAir 4C - Front and Rear axle
- V 00 VB-FullAir 2C - Extension kit

FIAT | SCUDO KO > 2021-CURRENT

- V 00 VB-CoilSpring
- V 01 VB-FullAir 2C - Rear axle

FIAT | TALENTO X82 > 2014-2021

- V 00 VB-CoilSpring
- V 00 VB-NivoAir
- V 00 VB-FullAir 2C - Rear axle

FIAT | DUCATO X230/X244 > 1994-2006

- V 02 VB-CoilSpring
- V 02 VB-SemiAir

FIAT AL-KO | DUCATO X230/X244 > 1994-2006

- V 02 VB-CoilSpring

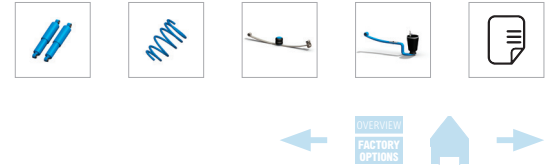

FIAT I DUCATO X250/X290 > 2006-CURRENT

- V 00 VB-SpecialParts
- V 00 VB-CoilSpring
- V 05 VB-SemiAir
- V 01 VB-FullAir 2C - Front axle
- V 02 VB-FullAir 2C - Rear axle
- V 00 VB-FullAir 2C - Modification set
- V 02 VB-FullAir 4C - Front and Rear axle
- V 02 VB-FullAir 2C - Extension kit

FIAT AL-KO I DUCATO X250/X290 > 2006-CURRENT

- V 00 VB-SpecialParts
- V 00 VB-CoilSpring
- V 00 VB-SemiAir
- V 00 VB-FullAir 2C - Front axle
- V 00 VB-FullAir 2C - Rear axle - Single Axle
- V 00 VB-FullAir 2C - Rear axle - Twin Axle
- V 01 VB-FullAir 4C - Front and Rear axle
- V 00 VB-FullAir 2C - Extension kit

FORD I RANGER T6/T7/T8 > 2011-2022

- V 01 VB-SemiAir
- V 01 VB-FullAir 2C - Rear axle

FORD I RANGER P703 > 2023-CURRENT

- V 00 VB-SemiAir

FORD I TRANSIT TOURNEO CONNECT > 2021-CURRENT

- V 00 VB-FullAir 2C - Rear axle

FORD I TRANSIT CUSTOM V362 > 2013-2023

- V 03 VB-CoilSpring
- V 02 VB-SemiAir

FORD I TRANSIT > 2006-2014

- V 01 VB-SemiAir

FORD I TRANSIT V363 > 2014-CURRENT

- V 01 VB-SemiAir
- V 02 VB-FullAir 2C FWD - Rear axle - VAN / Skeletal chassis
- V 01 VB-FullAir 2C RWD/4x4 - Rear axle
- V 02 VB-FullAir 2C 4.7-5T DRW - Rear axle - Chassis-Cabin
- V 01 VB-FullAir 2C RWD Electric VAN - Rear axle
- V 00 VB-FullAir 2C RWD Electric Chassis-Cabin - Rear axle

HYUNDAI I H350 > 2015-CURRENT

- V 01 VB-SemiAir

ISUZU I D-MAX ATFS86 > 2012-2020

- V 00 VB-SemiAir



ISUZU | D-MAX > 2021-CURRENT

V 02 VB-SemiAir

IVECO | DAILY > 1999-CURRENT

V 02 VB-SemiAir

V 00 VB-FullAir 2C - 35C-40C 1999-current - Rear axle

V 00 VB-FullAir 2C - 35C-40C 1999-current - Rear axle - Mini-artic ext. air supply

V 00 VB-FullAir 2C - 45C-50C 1999-current - Rear axle

V 00 VB-FullAir 3C - 45C-50C 2006-current - Front and Rear axle - Camping Car

V 00 VB-FullAir 4C - 45C-50C 2006-current - Front and Rear axle - Camping Car

V 01 VB-FullAir 2C - 60C-70C 1999-current - Rear axle

V 00 VB-FullAir 2C - 60C-70C 2006-current - Rear axle - Camping Car

V 00 VB-FullAir 3C - 60C-70C 2006-current - Front and Rear axle - Camping Car

V 00 VB-FullAir 4C - 60C-70C 2006-current - Front and Rear axle - Camping Car

V 01 VB-FullAir 2C extension kit - 60C-70C 2006-current with OEM Iveco rear axle - Front axle - Camping Car

V 00 VB-FullAir 2C - 60C-70C 2006-current - Extension kit

V 01 VB-ActiveAir 4C - 60C-70C 2006-current - Front and Rear axle - Camping Car

V 02 VB-FullAir 2C Extension Kit front + VB-ActiveAir Extension kit - 60C-70C 2013-current - Front and Rear axle - Camping Car

V 02 VB-ACTIVEAIR EXTENSION KIT - 60C-70C 2013-CURRENT - FRONT AND REAR AXLE - CAMPING CAR

LANDROVER | DEFENDER 90/110/130 > 1985-2016

V 00 VB-FullAir 2C - Rear axle

V 00 VB-FullAir 4C - Front and Rear axle

MAN | TGE > 2017-CURRENT

V 00 VB-CoilSpring

V 02 VB-SemiAir

V 00 VB-FullAir 2C 3.0t-4.0t FWD VAN Electric - Rear axle

V 00 VB-FullAir 2C 3.0t-4.0t FWD VAN/Flatframe chassis - Rear axle

V 00 VB-FullAir 2C 3.0t-4.0t FWD Chassis-Cabin - Rear axle

V 00 VB-FullAir 2C 3.0t-4.0t RWD/4x4 VAN - Rear axle

V 00 VB-FullAir 2C 3.0t-4.0t RWD/4x4 Chassis Cabin - Rear axle

V 00 VB-FullAir 2C DRW - Rear axle

MERCEDES-BENZ | CITAN > 2012-2020

V 00 VB-FullAir 2C - Rear axle

MERCEDES-BENZ | G-CLASS > 1990-2017

V 02 VB-FullAir 4C - Front and Rear axle

MERCEDES-BENZ | X-CLASS > 2018-CURRENT

V 00 VB-CoilSpring

V 00 VB-FullAir 2C - Rear axle

MERCEDES-BENZ | VITO/VIANO > 2003-2014

V 00 VB-CoilSpring

V 00 VB-FullAir 2C - Rear axle

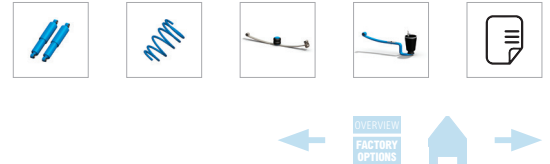

MERCEDES-BENZ | VITO/V-CLASS > 2014-CURRENT

- V 01 VB-CoilSpring
- V 00 VB-FullAir 2C - Rear axle
- V 00 VB-FullAir 2C - Rear axle - +30mm
- V 00 VB-FullAir 4C RWD - Front and Rear axle
- V 00 VB-FullAir 4C 4x4 - Front and Rear axle
- V 00 VB-FullAir 4C 4x4 +30mm - Front and Rear axle
- V 00 VB-FullAir 2C - Extension kit

MERCEDES-BENZ | SPRINTER NCV2 > 1996-2006

- V 00 VB-CoilSpring
- V 00 VB-SemiAir

MERCEDES-BENZ AL-KO | SPRINTER NCV 3 > 2006-2018

- V 00 VB-FullAir 2C 3XX AL-KO - Rear axle
- V 00 VB-FullAir - Modification set - Rear axle

MERCEDES-BENZ | SPRINTER NCV3 > 2006-2018

- V 00 VB-SpecialParts
- V 00 VB-CoilSpring
- V 03 VB-SemiAir
- V 00 VB-FullAir 2C 2XX-3XX - Rear axle
- V 00 VB-FullAir 2C 4XX-5XX - Rear axle
- V 00 VB-FullAir 2C 4XX-5XX - Rear axle - Mini-artic ext. air supply
- V 00 VB-FullAir 2C 4XX-5XX - Rear axle - Level +25mm
- V 00 VB-FullAir 2C 4XX-5XX - Rear axle - 4x4

MERCEDES-BENZ AL-KO AMC | SPRINTER VS30 > 2018-CURRENT

- V 00 VB-SemiAir
- V 07 VB-FullAir 2C AL-KO AMC 4XX 4x2 - Rear axle
- V 07 VB-FullAir 2C AL-KO AMC 5XX 6x2 - Rear axle
- V 04 VB-FullAir 4C AL-KO AMC 4XX 4x2 - Front and rear axle
- V 04 VB-FullAir 4C AL-KO AMC 5XX 6x2 - Front and rear axle
- V 03 VB-FullAir 2C - Extension kit

MERCEDES-BENZ | SPRINTER VS30 > 2018-CURRENT

- V 00 VB-CoilSpring
- V 02 VB-SemiAir
- V 01 VB-FullAir 2C 2XX-3XX-4XX FWD - Rear axle
- V 01 VB-FullAir 2C 2XX-3XX-4XX RWD - Rear axle
- V 03 VB-FullAir 2C 2XX-3XX-4XX - Rear axle - 4X4
- V 01 VB-FullAir 2C 5XX - Rear axle
- V 01 VB-FullAir 2C 5XX - Rear axle - Level +25mm
- V 01 VB-FullAir 2C 5XX - 4x4



NISSAN | NAVARA D40 > 2004-2014

V 00 VB-SemiAir

NISSAN | NAVARA D23 > 2015-CURRENT

V 00 VB-CoilSpring

V 00 VB-SemiAir

V 00 VB-FullAir 2C - Rear axle

NISSAN | E-NV200 > 2014-CURRENT

V 01 VB-SemiAir

V 01 VB-SemiAir

NISSAN | PRIMASTAR X83 > 2001-2014

V 00 VB-CoilSpring

V 00 VB-FullAir 2C - Rear axle

NISSAN | NV300 PRIMASTAR > 2014-CURRENT

V 00 VB-CoilSpring

V 00 VB-NivoAir

V 00 VB-FullAir 2C - Rear axle

NISSAN | INTERSTAR X70 > 1998-2010

V 00 VB-SemiAir

NISSAN | NV400 INTERSTAR > 2010-CURRENT

V 00 VB-CoilSpring

V 00 VB-SemiAir

V 00 VB-FullAir 2C FWD - Rear axle

V 01 VB-FullAir 2C RWD - Rear axle

V 00 VB-FullAir 2C DRW - Rear axle

V 00 VB-FullAir 2C DRW - Rear axle - Mini-artic ext. air supply

NISSAN | CABSTAR F24 > 2007-CURRENT

V 00 VB-FullAir 2C - Rear axle

V 00 VB-FullAir 2C - Rear axle - Mini-artic ext. air supply

OPEL | VIVARO X83 > 2001-2014

V 00 VB-CoilSpring

V 00 VB-FullAir 2C - Rear axle

OPEL | VIVARO X82 > 2014-2019

V 00 VB-CoilSpring

V 00 VB-NivoAir

V 00 VB-FullAir 2C - Rear axle

OPEL | VIVARO/ZAFIRA LIFE K0 > 2019-CURRENT

V 00 VB-CoilSpring

V 01 VB-FullAir 2C - Rear axle



OPEL | MOVANO X70 > 1998-2010

V 00 VB-SemiAir

OPEL | MOVANO X62 > 2010-2021

V 00 VB-CoilSpring

V 00 VB-SemiAir

V 00 VB-FullAir 2C FWD - Rear axle

V 01 VB-FullAir 2C RWD - Rear axle

V 00 VB-FullAir 2C DRW - Rear axle

V 00 VB-FullAir 2C DRW - Rear axle - Mini-artic ext. air supply

OPEL | MOVANO X290 > 2022-CURRENT

V 00 VB-SpecialParts

V 00 VB-CoilSpring

V 05 VB-SemiAir

V 01 VB-FullAir 2C - Front axle

V 02 VB-FullAir 2C - Rear axle

V 00 VB-FullAir 2C - Modification set

V 02 VB-FullAir 4C - Front and Rear axle

V 02 VB-FullAir 2C - Extension kit

PEUGEOT | EXPERT/TRAVELLER K0 > 2017-CURRENT

V 00 VB-CoilSpring

V 01 VB-FullAir 2C - Rear axle

PEUGEOT | BOXER X230/X244 > 1994-2006

V 02 VB-CoilSpring

V 02 VB-SemiAir

PEUGEOT AL-KO | BOXER X230/X244 > 1994-2006

V 02 VB-CoilSpring

PEUGEOT | BOXER X250/X290 > 2006-CURRENT

V 00 VB-SpecialParts

V 00 VB-CoilSpring

V 05 VB-SemiAir

V 01 VB-FullAir 2C - Front axle

V 02 VB-FullAir 2C - Rear axle

V 00 VB-FullAir 2C - Modification set

V 02 VB-FullAir 4C - Front and Rear axle

V 02 VB-FullAir 2C - Extension kit



PEUGEOT AL-KO | BOXER X250/X290 > 2006-CURRENT

- V 00 VB-SpecialParts
- V 00 VB-CoilSpring
- V 00 VB-SemiAir
- V 00 VB-FullAir 2C - Front axle
- V 00 VB-FullAir 2C - Rear axle - Single Axle
- V 00 VB-FullAir 2C - Rear axle - Twin Axle
- V 01 VB-FullAir 4C - Front and Rear axle
- V 00 VB-FullAir 2C - Extension kit

RENAULT | KANGOO > 2012-2020

- V 00 VB-FullAir 2C - Rear axle

RENAULT | ALASKAN > 2017-CURRENT

- V 00 VB-CoilSpring
- V 00 VB-SemiAir
- V 00 VB-FullAir 2C - Rear axle

RENAULT | TRAFIC X83 > 2001-2014

- V 00 VB-CoilSpring
- V 00 VB-FullAir 2C - Rear axle

RENAULT | TRAFIC X82 > 2014-CURRENT

- V 00 VB-CoilSpring
- V 00 VB-NivoAir
- V 00 VB-FullAir 2C - Rear axle

RENAULT | MASTER X70 > 1998-2010

- V 00 VB-SemiAir

RENAULT | MASTER X62 > 2010-CURRENT

- V 00 VB-CoilSpring
- V 00 VB-SemiAir
- V 00 VB-FullAir 2C FWD - Rear axle
- V 01 VB-FullAir 2C RWD - Rear axle
- V 00 VB-FullAir 2C DRW - Rear axle
- V 00 VB-FullAir 2C DRW - Rear axle - Mini-artic ext. air supply

RENAULT | MAXITY F24 > 2007-CURRENT

- V 00 VB-FullAir 2C - Rear axle
- V 00 VB-FullAir 2C - Rear axle - Mini-artic ext. air supply

TOYOTA | PROACE/PROACE VERSO KO > 2017-CURRENT

- V 00 VB-CoilSpring
- V 01 VB-FullAir 2C - Rear axle

TOYOTA | HILUX AN10/AN20/AN30 > 2004-2015

- V 00 VB-SemiAir

TOYOTA | HILUX AN120/AN130 > 2015-CURRENT

- V 00 VB-SemiAir



VOLKSWAGEN | CADDY > 2004-2019

V 00 VB-FullAir 2C - Rear axle

VOLKSWAGEN | CADDY MK5 > 2021-CURRENT

V 02 VB-FullAir 2C - Rear axle

V 02 VB-FullAir 2C - Rear axle

VOLKSWAGEN | AMAROK > 2009-2021

V 01 VB-SemiAir

V 01 VB-FullAir 2C - Rear axle

VOLKSWAGEN | AMAROK > 2023-CURRENT

V 00 VB-SemiAir

VOLKSWAGEN | TRANSPORTER T5/T6/T6.1 > 2003-CURRENT

V 00 VB-SpecialParts

V 00 VB-CoilSpring - T5/T6/T6.1

V 00 VB-NivoAir - T6/T6.1

V 00 VB-FullAir 2C - Rear axle - T6/T6.1

V 00 VB-FullAir 2C - Rear axle - T6/T6.1 +30mm

V 00 VB-FullAir 2C - Extension kit

V 00 VB-FullAir 4C - Front and Rear axle - T6/T6.1 2,6t - 3,08t

V 00 VB-FullAir 4C - Front and Rear axle - T6/T6.1 2,6t - 3,08t +30mm

V 00 VB-FullAir 4C - Front and Rear axle - T6/T6.1 3,08t - 3,2t Maxi

V 00 VB-FullAir 4C - Front and Rear axle - T6/T6.1 3,08t - 3,2t +30mm Maxi

VOLKSWAGEN | LT28-46A > 1996-2006

V 00 VB-CoilSpring

V 00 VB-SemiAir

VOLKSWAGEN | CRAFTER > 2006-2016

V 00 VB-SpecialParts

V 00 VB-CoilSpring

V 02 VB-SemiAir

V 00 VB-FullAir 2C 35-50 DRW + Super Single - Rear axle

V 00 VB-FullAir 2C 35-50 DRW + Super Single - Rear axle - Mini-artic ext. air supply

V 00 VB-FullAir 2C 35-50 DRW + Super Single - Rear axle - Level +25mm

VOLKSWAGEN | CRAFTER > 2017-CURRENT

V 00 VB-CoilSpring

V 02 VB-SemiAir

V 00 VB-FullAir 2C 3.0t-4.0t FWD VAN Electric - Rear axle

V 00 VB-FullAir 2C 3.0t-4.0t FWD VAN/Flatframe chassis - Rear axle

V 00 VB-FullAir 2C 3.0t-4.0t FWD Chassis-Cabin - Rear axle

V 00 VB-FullAir 2C 3.0t-4.0t RWD/4x4 VAN - Rear axle

V 00 VB-FullAir 2C 3.0t-4.0t RWD/4x4 Chassis Cabin - Rear axle

V 00 VB-FullAir 2C DRW - Rear axle



ANNEX I ALL BRANDS I

V 00	VBA-SB2012-001	Choosing the mount spacers - VB-FullAir	Mercedes-benz Sprinter/Volkswagen Crafter
V 03	VBA-TB2012-002	Vehicle identification of exception VB-SemiAir	Ford Transit
V 06	VBA-SB2014-001	Choosing the right kit - VB-SemiAir	Citroën Jumper /Fiat Ducato/Peugot Boxer AL-KO X250/X290
V 03	VBA-TB2014-003	Mercedes-Benz Sprinter 4XX-5XX/Volkswagen Crafter	It 35-50
V 01	VBA-TB2016-003	Choosing the right suspension struts	Volkswagen Transporter T5/T6
V 02	VBA-GB2017-002	Choosing the right kit - VB-CoilSpring	Citroën Jumper/Fiat Ducato/Peugot Boxer AL-KO X250/X290
V 01	VBA-GB2017-004	Choosing the right kit - VB-CoilSpring	Mercedes-Benz X-Class/Nissan Navara D23/Renault Alaskan
V 01	VBA-GB2017-003	Choosing the right kit - VB-SemiAir	Iveco Daily
V 03	VBA-GB2017-005	Choosing the right FSD-technology	Citroën Jumper/Fiat Ducato/ Peugeot Boxer AL-KO X250/X290
V 02	VBA-TB2017-008	VB-SemiAir - Platform cab.	Ford Transit V363
V 01	VBA-SB2018-001	Choosing the right kit - VB-CoilSpring	Citroën Jumper/Fiat Ducato/ Peugeot Boxer AL-KO AMC X250/X290
V 04	VBA-GB2019-001	Identifying the VB-FullAir AL-KO Chassis	Citroën Jumper/Fiat Ducato/ Peugeot Boxer AL-KO X250/X290
V 00	VBA-SB2019-001	Check for ADAS calibration	All brands/types
V 00	VBA-SB2019-002	Options VB-FullAir 2C/3C/4C	All brands/types
V 07	VBA-GB2020-001	Choosing the right kit VB-SemiAir	Ford Transit V362-V363
V 03	VBA-GB2020-005	Identifying the dashboard	Nissan NV400/Opel Movano/ Renault Master X62
V 01	VBA-SB2021-003	Important notes to comply with Volkswagen's LONO regulations	MAN TGE/Volkswagen Crafter
V 02	VBA-GB2022-001	Identifying the dashboard	Mercedes-Benz Sprinter VS30
V 07	VBA-SB2022-001	Overview and explanation of all factory codes	All brands/types
V 02	VBA-SB2022-002	VB-FullAir - Can-bus interface	Mercedes-Benz Sprinter VS30
V 02	VBA-SB2022-003	How to use the AL-KO search engine	VB-SemiAir-VB-FullAir
V 00	VBA-SB2022-004	Identifying VB-CoilSpring - Mercedes-Benz Vito-V-Class	
V 02	VBA-SB2022-006	Choosing the right kit - Fiat Ducato X290 (EURO-6D)	
V 00	Tyres/Rims/Spacers	Iveco Daily	



REVISION OVERVIEW

Brand	Type	Specification	Productgroup	Version	Page(s)	Note
Overbook overview	-	-	-	V 14	1	-
Table of contents	-	-	-	V 14	2-10	-
Revision overview	-	-	-	V 14	11	-
Factory options	-	-	-	V 07	12-15	-

THE FOLLOWING SHEETS HAVE BEEN EDITED.

Citroën	Jumper	X290	VB-SemiAir	V 06	24,27	Kit 1552350048 replaced by 1552350047.
Fiat	Ducato	X290	VB-SemiAir	V 06	58,61	Kit 1552350048 replaced by 1552350047.
Ford	Transit	V362	VB-CoilSpring	V 03	87,88	Kit 1700616200, 1700616201 & 1700616202 sold out.
Ford	Transit	V363	VB-FullAir	V 05	92,95-97	Added extra note.
Hyundai		H350	VB-SemiAir	V 01	100,101	Kit 1551507200 & VB-SA-H350-01B sold out.
Iveco	Daily		VB-FullAir	V 04	106,114 118 120-122	Added new partnumbers. Added extra note. Added new partnumbers.
Mercedes-Benz	Sprinter	VS30 AL-KO	VB-SemiAir	V 07	168-169	Added new partnumbers.
			VB-FullAir		170-172 173-174	Added extra note. Edited extra note.
Mercedes-Benz	Sprinter	VS30	VB-SemiAir	V 05	175,177-178	Edited extra note.
Opel	Movano	X290	VB-SemiAir	V 06	231,234	Kit 1552350048 replaced by 1552350047.
Peugeot	Boxer	X290	VB-SemiAir	V 06	248,251	Kit 1552350048 replaced by 1552350047.



Extra! Shortcuts to the overview and explanation factory options page have been added. These are displayed with the 'overview factory options icon' at the top of every page in the interactive PDF.



Extra! Indicates that there is refer to a bulletin in the annex. These are displayed with the 'annex icon' before the extra note in the interactive PDF.

We will advise you to take into account any additional costs of an ADAS calibration that may appear on the quotation to avoid any surprises afterwards.

For more information on this subject, please refer to VBA-SB2019-001-EN in the attachment.



OVERVIEW AND EXPLANATION OF ALL FACTORY CODES

CITROËN

Code	Description
CZ02	Increased payload
GA04	Increased ride height/hard road conditions
JI01	Coachbuilder's socket (bodybuilder connector for signals)
QB02	Rear axle with wide track (1980mm instead of 1790mm)

FIAT

Code	Description
026	Electric parking brake
062	Rear anti-rollbar
081	Coachbuilder's socket (bodybuilder connector for signals)
58G	Rear axle with wide track (1980mm instead of 1790mm)
78Z	Composite leaf springs
CZ02	Increased payload
GA04	Increased ride height/hard road conditions

FORD

Code	Description
AALA3	WAV Conversion
A813	Rear Air Conditioning
JRSAB	Programmable interface for extension (UIS Module)

MAN

Code	Description
5S4	Electric liftgate preparation
637QB	Second battery
637QC	Second battery
637QD	Second battery
637QE	Second battery
637QG	Second battery
7U4	Circuit for leaving the engine running after taking out the key
8FB	Second battery
8FD	Second battery
8FE	Second battery
8FG	Second battery
8FH	Second battery
8FK	Second battery
IL2	Acoustic warning when reverse gear is engaged, deactivatable
IS2	Interface for external use (KFG Module)
IS3	Interface for external use (KFG Module)
IS7	Interface for external use (KFG Module)
IS8	Interface for external use (KFG Module)
U9B	Twin USB-port



UG5	Hill descent control
YRB	Flashing light on/off

MERCEDES-BENZ

Code	Description
AL1	Bad road condition version
B01	High centre of gravity ESC
B25	Electric parking brake
C15	Lowered chassis
C17	Springs for lowered chassis
C2B	Drive height 20mm higher
C33	Firmer rear springs
C83	GFK main spring, (composite)
CE8	Raised chassis
CW2	Chassis on normal drive height
-CW2	Lowered chassis
ED5	PSM module, interface for external use
EK1	15+ (contact plus), electric fitting point in vehicle
G42	7G-TRONIC Plus
G43	Automatic transmission 9G-TRONIC
K60	Exhaust straight to rear
LG1	Xenon headlights (Sprinter NCV3)
LG7	LED Headlights (Sprinter VS30)
M1E	Electric motor 150 kW
T55	Electrical operation of sliding door, right
XL8	Weight variant 3880KG
Z11/Z12/Z45	Bad road condition version
ZU7	National version for Canada
ZU8	National version for USA

NISSAN/RENAULT

Code	Description
CABADP	15+ (contact plus) electric fitting point in vehicle
PKNAG1	Double DIN navigation device
PKNB02	Double DIN navigation device
PKNB05	Double DIN navigation device
PKNVG2	Double DIN navigation device

OPEL

Code	Description
CZ202	Increase payload
GA04	Increased ride height/hard road conditions
KPD	15+ (contact plus) electric fitting point in vehicle
WRF	Coachbuilder's socket (bodybuilder connector for signals)



PEUGEOT

Code	Description
CZ202	Increase payload
GA04	Increased ride height/hard road conditions
JI01	Coachbuilder's socket (bodybuilder connector for signals)
QB02	Rear axle with wide track (1980mm instead of 1790mm)

VOLKSWAGEN

Code	Description
1BA	Front axle weight is <1680 standard front axle
1BB	Front axle weight is <1680 standard front axle
1BH	Front axle weight is >1680 maxi front axle
1BJ	Front axle weight is <1680 standard front axle
1BL/1BQ	DCC Dynamic Drive Control
1SB	Rough road version
2MD	Front axle weight is <1680 standard front axle
2MF	Front axle weight is <1680 standard front axle
2MG	Front axle weight is <1680 standard front axle
2MH	Front axle weight is <1680 standard front axle
2MK	Front axle weight is <1680 standard front axle
2MQ	Front axle weight is >1680 maxi front axle
2MR	Front axle weight is >1680 maxi front axle
2MT	Front axle weight is >1680 maxi front axle
2MU	Front axle weight is >1680 maxi front axle
5S4	Electric liftgate preparation
7U4	Circuit for leaving the engine running after taking out the key
7VF	Fuel-fired parking heater with radio remote control and electric auxiliary heater
7VL	Parking heater, Water heater with radio remote control
8FB	Second battery
8FD	Second battery
8FE	Second battery
8FG	Second battery
8FH	Second battery
8FK	Second battery
8FL	Second battery
9AH	Climatronic with second evaporator and second heating system
IL2	Acoustic warning when reverse gear is engaged, deactivatable
IP3	Interface for external use
IP4	Preparation for interface for external use, with terminal block 15+ (contact plus)
IS1	15+ (contact plus)
IS2	Interface for external use (KFG Module)
IS3	Interface for external use (KFG Module)
IS5	Interface for external use
IS7	Interface for external use (KFG Module)
IS8	Interface for external use (KFG Module)
P4V	WAV Conversion
P7B/P7C	DCC Dynamic Drive Control



PL7	Xenon headlights
U9B	Twin USB-port
U9B	Twin USB-port
UF3	Electric clamping strip (+15)
UG5	Hill descent control
YRB	Flashing light on/off

TOYOTA

Code	Description
CZ02	Increased payload
GA04	Increased ride height/hard road conditions



- + CITROËN
- + JUMPER X250/X290
- + 2006-CURRENT

Latest price update: 01-11-2024

VB-SPECIALPARTS

V 00

VB-COILSPRING

V 00

VB-SEMIAIR

V 05

VB-FULLAIR 2C - FRONT AXLE

V 01

VB-FULLAIR 2C - REAR AXLE

V 02

VB-FULLAIR 2C - MODIFICATION SET

V 00

VB-FULLAIR 4C - FRONT AND REAR AXLE

V 02

VB-FULLAIR 2C - EXTENSION KIT

V 02



VB-SEMIAIR

Kit	Axle	Remark	Fitting time	Partnumber	Price
VB-SemiAir	rear	base	3-4	1550307100	€ 497,50
VB-SemiAir	rear	comfort-LCV	4-5	VBSA-X250-01B	€ 882,50
VB-SemiAir	rear	comfort-LCV RHD	4-5	VBSA-X250-01BUK	€ 882,50
VB-SemiAir	rear	comfort-camper	4-5	VBSA-X250-01C	€ 882,50
VB-SemiAir	rear	comfort-camper RHD	4-5	VBSA-X250-01CUK	€ 882,50
VB-SemiAir	rear	comfort-camper LHD (EPB)	4-5	VBSA-X250-02C*	€ 882,50
VB-SemiAir	rear	comfort-digital	4	VBSA-X250-03	€ 995,00

ATTENTION MANDATORY PART

Description

If the PFCO X290 is equipped with factory option code 062 (stabilizer bar) and factory option code 026 (electric parking brake), the modification stabilizer bar 1552350047 needs to be ordered. The kit fits on a normal track and wide track.

* **VBSA-X250-02C will not fit RHD (Right Hand Drive) vehicles.**

Description	Fitting time	Partnumber	Price
Modification stabiliser bar (not discountable)	2	1552350047	€ 100,00

When the vehicle is equipped with heated seats or an air-suspended driver's seat, the comfort-LCV kit does not fit.

When the vehicle is equipped with a parking heater or electric parking brake (option 026), the comfort-camper kit VBSA-X250-01C(UK) does not fit.

OPTIONS BELONGING TO KIT:

1550307100

Description	Fitting time	Partnumber	Price
VB-SA Single manometer kit	0,50	1505370049	€ 47,50
VB-SA Dual manometer kit	0,50	1505370050	€ 87,50
VB-CK2 Universal compressor kit	1	1555370102	€ 410,00
Extension for base kit to comfort kit universal	2	1555370218	€ 497,50
Extension for base kit to comfort kit universal DIN slot	2	1555370217	€ 497,50
Extension for base kit to comfort kit LCV	1-2	1555370202	€ 497,50
Extension for base kit to comfort kit LCV RHD	1-2	1555370203	€ 497,50
Extension for base kit to comfort kit camper	1-2	1555370200	€ 497,50
Extension for base kit to comfort kit camper RHD	1-2	1555370201	€ 497,50
Extension for base kit to comfort kit camper LHD (EPB)	1-2	1555370238	€ 497,50
Extension for base kit to comfort kit digital	1	1555370243	€ 617,50
Extension for base kit to VB-LevelAir kit universal	3	1565370228	€ 1.212,50



- + FIAT
- + DUCATO X250/X290
- + 2006-CURRENT

Latest price update: 01-11-2024

VB-SPECIALPARTS

V 00

VB-COILSPRING

V 00

VB-SEMIAIR

V 05

VB-FULLAIR 2C - FRONT AXLE

V 01

VB-FULLAIR 2C - REAR AXLE

V 02

VB-FULLAIR 2C - MODIFICATION SET

V 00

VB-FULLAIR 4C - FRONT AND REAR AXLE

V 02

VB-FULLAIR 2C - EXTENSION KIT

V 02



VB-SEMIAIR

Kit	Axle	Remark	Fitting time	Partnumber	Price
VB-SemiAir	rear	base	3-4	1550307100	€ 497,50
VB-SemiAir	rear	comfort-LCV	4-5	VBSA-X250-01B	€ 882,50
VB-SemiAir	rear	comfort-LCV RHD	4-5	VBSA-X250-01BUK	€ 882,50
VB-SemiAir	rear	comfort-camper	4-5	VBSA-X250-01C	€ 882,50
VB-SemiAir	rear	comfort-camper RHD	4-5	VBSA-X250-01CUK	€ 882,50
VB-SemiAir	rear	comfort-camper LHD (EPB)	4-5	VBSA-X250-02C*	€ 882,50
VB-SemiAir	rear	comfort-digital	4	VBSA-X250-03	€ 995,00

ATTENTION MANDATORY PART

Description

If the PFCO X290 is equipped with factory option code 062 (stabilizer bar) and factory option code 026 (electric parking brake), the modification stabilizer bar

1552350047 needs to be ordered. The kit fits on a normal track and wide track.

*** VBSA-X250-02C will not fit RHD (Right Hand Drive) vehicles.**

Description	Fitting time	Partnumber	Price
Modification stabiliser bar (not discountable)	2	1552350047	€ 100,00

When the vehicle is equipped with heated seats or an air-suspended driver's seat, the comfort-LCV kit does not fit.

When the vehicle is equipped with a parking heater or electric parking brake (option 026), the comfort-camper kit VBSA-X250-01C(UK) does not fit.

OPTIONS BELONGING TO KIT:

1550307100

Description	Fitting time	Partnumber	Price
VB-SA Single manometer kit	0,50	1505370049	€ 47,50
VB-SA Dual manometer kit	0,50	1505370050	€ 87,50
VB-CK2 Universal compressor kit	1	1555370102	€ 410,00
Extension for base kit to comfort kit universal	2	1555370218	€ 497,50
Extension for base kit to comfort kit universal DIN slot	2	1555370217	€ 497,50
Extension for base kit to comfort kit LCV	1-2	1555370202	€ 497,50
Extension for base kit to comfort kit LCV RHD	1-2	1555370203	€ 497,50
Extension for base kit to comfort kit camper	1-2	1555370200	€ 497,50
Extension for base kit to comfort kit camper RHD	1-2	1555370201	€ 497,50
Extension for base kit to comfort kit camper LHD (EPB)	1-2	1555370238	€ 497,50
Extension for base kit to comfort kit digital	1	1555370243	€ 617,50
Extension for base kit to VB-LevelAir kit universal	3	1565370228	€ 1.212,50



- + FORD
- + TRANSIT CUSTOM V362
- + 2013-2023

Latest price update: 01-11-2024

VB-COILSPRING
VB-SEMIAIR

V 03

V 02



VB-COILSPRING

Kit	Axle	Remark	Fitting time	Partnumber	Price
VB-CoilSpring	rear	helper 260-320 + sport van	2	-	SOLD OUT
VB-CoilSpring	rear	helper (air conditioning in passenger compartment)	2	-	SOLD OUT
VB-CoilSpring	rear	helper 330-340	2	-	SOLD OUT

**Kits doesn't fit on vehicle with air conditioning in the back (passenger compartment).*



- + FORD
- + TRANSIT V363
- + 2014-CURRENT

Latest price update: 01-11-2024

VB-SEMIAIR

V 01

VB-FULLAIR 2C FWD - REAR AXLE - VAN / SKELETAL CHASSIS

V 02

VB-FULLAIR 2C RWD/4X4 - REAR AXLE

V 01

VB-FULLAIR 2C 4.7-5T DRW - REAR AXLE - CHASSIS-CABIN

V 02

VB-FULLAIR 2C RWD ELECTRIC VAN - REAR AXLE

V 01

VB-FULLAIR 2C RWD ELECTRIC CHASSIS-CABIN - REAR AXLE

V 00



VB-FULLAIR 2C FWD - REAR AXLE - VAN / SKELETAL CHASSIS

Kit	Axle	Remark	Fitting time	Partnumber	Price
VB-FullAir 2C FWD VAN	rear	330-350*	8	1050618200	€ 4.420,00
VB-FullAir 2C FWD VAN	rear	290-310*	8	1050618202	€ 4.420,00

**Kits do not fit on MY2024 facelift vehicles*

**Kits do not fit on vehicles equipped with factory code A813 Rear Air Conditioning.*

**Kits do not fit on vehicles with Skeletal chassis Length 5.*

VB-ASCU SOFTWARE + REMOTE BELONGING TO KIT: 1050618200

Description	Remote	Targetgroup	Partnumber	Price
Tip-follow, handbrake signal	2C standard	-	0080618221	€ -
Tip-follow, handbrake signal, extra-time module	2C standard	-	0080618222	€ 190,00
Tip (ride height - low), handbrake signal, extra-time module.	2C standard	ambulance	0080618223	€ 190,00
Tip-follow, handbrake signal, lowest position on bump	2C standard	car transporter	0080618225	€ -
Tip-follow, handbrake signal, lowest position on bump, extra-time module	2C standard	car transporter	0080618226	€ 190,00
Tip-follow, speed signal, hydraulic jacks	2C camper	motorhome	0080618261	€ -

VB-ASCU SOFTWARE + REMOTE BELONGING TO KIT: 1050618202

Description	Remote	Targetgroup	Partnumber	Price
Tip-follow, handbrake signal	2C standard	-	0080618201	€ -
Tip-follow, handbrake signal, extra-time module	2C standard	-	0080618202	€ 190,00
Tip (ride height - low), handbrake signal, extra-time module.	2C standard	ambulance	0080618203	€ 190,00
Tip-follow, handbrake signal, lowest position on bump	2C standard	car transporter	0080618205	€ -
Tip-follow, handbrake signal, lowest position on bump, extra-time module	2C standard	car transporter	0080618206	€ 190,00
Tip-follow, speed signal, hydraulic jacks	2C camper	motorhome	0080618260	€ -

OPTIONS BELONGING TO KIT: 1050618200, 1050618202

Description	Fitting time	Partnumber	Price
Extra rear-door switch	0,50	1052201092	€ 50,00
Emergency inflation valves	1	1052250513	€ 90,00

CALIBRATION TOOLS BELONGING TO KIT: 1050618200

Description	Axle	X-Value	Partnumber	Price
Calibration support kit	rear	180mm	0090000119	€ 50,00

CALIBRATION TOOLS BELONGING TO KIT: 1050618202

Description	Axle	X-Value	Partnumber	Price
Calibration support kit	rear	142mm	0090000118	€ 50,00



VB-FULLAIR 2C RWD/4X4 - REAR AXLE

Kit	Axle	Remark	Fitting time	Partnumber	Price
VB-FullAir 2C RWD/4x4 - Rear axle	rear	van (Euro-5 & Euro-6)	8	1050619201*	€ 4.425,00

**Kits do not fit on MY2024 facelift vehicles*

**Kit not available for NAFTA vehicles.*

VB-ASCU SOFTWARE + REMOTE BELONGING TO KIT: 1050619201

Description	Remote	Targetgroup	Partnumber	Price
Tip-follow, handbrake signal	2C standard	-	0080619201	€ -
Tip-follow, handbrake signal, extra-time module	2C standard	-	0080619202	€ 190,00
Tip (ride height - low), handbrake signal, extra-time module.	2C standard	ambulance	0080619203	€ 190,00
Tip-follow, handbrake signal, lowest position on bump	2C standard	car transporter	0080619205	€ -
Tip-follow, handbrake signal, lowest position on bump, extra-time module	2C standard	car transporter	0080619206	€ 190,00

OPTIONS BELONGING TO KIT: 1050619201

Description	Fitting time	Partnumber	Price
Extra rear-door switch	0,50	1052201092	€ 50,00
Emergency inflation valves	1	1052250513	€ 90,00

CALIBRATION TOOLS BELONGING TO KIT: 1050619201

Description	Axle	X-Value	Partnumber	Price
Calibration support kit	rear	150mm	0090000082A	€ 30,00



VB-FULLAIR 2C 4.7-5T DRW - REAR AXLE - CHASSIS-CABIN

Kit	Axle	Remark	Fitting time	Partnumber	Price
VB-FullAir 2C DRW	rear	chassis-cabin	8	1050620200	€ 4.800,00

**Kits do not fit on MY2024 facelift vehicles*

VB-ASCU SOFTWARE + REMOTE BELONGING TO KIT: 1050620200

Description	Remote	Targetgroup	Partnumber	Price
Tip-follow, handbrake signal	2C standard	-	0080620201	€ -
Tip-follow, handbrake signal, extra-time module	2C standard	-	0080620202	€ 190,00
Tip (ride height - low), handbrake signal, extra-time module.	2C standard	ambulance	0080620203	€ 190,00
Tip-follow, handbrake signal, lowest position on bump	2C standard	car transporter	0080620205	€ -
Tip-follow, handbrake signal, lowest position on bump, extra-time module	2C standard	car transporter	0080620206	€ 190,00

OPTIONS BELONGING TO KIT: 1050620200

Description	Fitting time	Partnumber	Price
Extra rear-door switch	0,50	1052201092	€ 50,00
Emergency inflation valves	1	1052250513	€ 90,00

CALIBRATION TOOLS BELONGING TO KIT: 1050620200

Description	Axle	X-Value	Partnumber	Price
Calibration support kit	rear	150mm	0090000085	€ 30,00



- + HYUNDAI
- + H350
- + 2015-CURRENT

Latest price update: 01-11-2024

VB-SEMIAIR

V 01



VB-SEMIAIR

Kit	Axle	Remark	Fitting time	Partnumber	Price
VB-SemiAir	rear	base	2	-	SOLD OUT
VB-SemiAir	rear	comfort-LCV	3	-	SOLD OUT

**Kit not available for RHD vehicles.*

OPTIONS BELONGING TO KIT:

1551507200

Description	Fitting time	Partnumber	Price
VB-SA Single manometer kit	0,50	1505370049	€ 47,50
VB-SA Dual manometer kit	0,50	1505370050	€ 87,50
Extension for base kit to comfort kit LCV	1	-	SOLD OUT
Extension for base kit to comfort kit Universal	2	1555370218	€ 497,50
Extension for base kit to comfort kit Universal DIN slot	2	1555370217	€ 497,50
Extension for base kit to VB-LevelAir kit universal	3	1565370228	€ 1.212,50



- + IVECO
- + DAILY
- + 1999-CURRENT

Latest price update: 01-11-2024

VB-SEMIAIR	V 02
VB-FULLAIR 2C - 35C-40C 1999-CURRENT - REAR AXLE	V 00
VB-FULLAIR 2C - 35C-40C 1999-CURRENT - REAR AXLE - MINI-ARTIC EXT. AIR SUPPLY	V 00
VB-FULLAIR 2C - 45C-50C 1999-CURRENT - REAR AXLE	V 00
VB-FULLAIR 3C - 45C-50C 2006-CURRENT - FRONT AND REAR AXLE - CAMPING CAR	V 00
VB-FULLAIR 4C - 45C-50C 2006-CURRENT - FRONT AND REAR AXLE - CAMPING CAR	V 00
VB-FULLAIR 2C - 60C-70C 1999-CURRENT - REAR AXLE	V 01
VB-FULLAIR 2C - 60C-70C 2006-CURRENT - REAR AXLE - CAMPING CAR	V 00
VB-FULLAIR 3C - 60C-70C 2006-CURRENT - FRONT AND REAR AXLE - CAMPING CAR	V 00
VB-FULLAIR 4C - 60C-70C 2006-CURRENT - FRONT AND REAR AXLE - CAMPING CAR	V 00
VB-FULLAIR 2C EXTENSION KIT - 60C-70C 2006-CURRENT WITH OEM IVECO REAR AXLE - FRONT AXLE - CAMPING CAR	V 01
VB-FULLAIR 2C - 60C-70C 2006-CURRENT - EXTENSION KIT	V 00
VB-ACTIVEAIR 4C - 60C-70C 2006-CURRENT - FRONT AND REAR AXLE - CAMPING CAR	V 01
VB-FULLAIR 2C EXTENSION KIT FRONT + VB-ACTIVEAIR EXTENSION KIT - 60C-70C 2013-CURRENT - FRONT AND REAR AXLE - CAMPING CAR	V 02
VB-ACTIVEAIR EXTENSION KIT - 60C-70C 2013-CURRENT - FRONT AND REAR AXLE - CAMPING CAR	V 02



VB-FULLAIR 2C - 60C-70C 1999-CURRENT - REAR AXLE

Kit	Axle	Remark	Fitting time	Partnumber	Price
VB-FullAir 2C 60C-70C 1999-current	rear		8	1050105260	€ 5.050,00

VB-ASCU SOFTWARE + REMOTE BELONGING TO KIT: 1050105260

Description	Remote	Targetgroup	Partnumber	Price
Tip-follow, handbrake signal	2C standard	-	0080105289	€ -
Tip-follow, handbrake signal, extra-time	2C standard	-	0080105290	€ 190,00
Tip-follow, handbrake signal, lowest position on bump	2C standard	car transporter	0080105291	€ -
Tip-follow, handbrake signal, lowest position on bump, extra-time	2C standard	car transporter	0080105292	€ 190,00
Tip-follow, speed signal	2C standard	-	0080105288	€ -

OPTIONS BELONGING TO KIT: 1050105260

Description	Fitting time	Partnumber	Price
Extra rear-door switch	0,50	1052201092	€ 50,00
Emergency inflation valves 2C	1	1052250511	€ 85,00

CALIBRATION TOOLS BELONGING TO KIT: 1050105260

Description	Axle	X-Value	Partnumber	Price
Calibration support	rear	130mm	0090000014	€ 30,00

OPTIONS BELONGING TO KIT: 1050105260

Description	Fitting time	Partnumber	Price
When the vehicle has the option electric handbrake order the extension kit.	-	1052350226	€ 56,50



VB-FULLAIR 2C EXTENSION KIT - 60C-70C 2006-CURRENT WITH OEM IVECO REAR AXLE - FRONT AXLE - CAMPING CAR

Kit	Axle	Remark	Fitting time	Partnumber	Price
VB-FullAir 2C Rear > 4C - Extension kit	front	camping car with OEM Iveco rear air suspension	10	1050105602*	€ 6.005,00

**This solution is only available for campers with a flat floor and raised cabin.*

**Kit will not fit the Air-Pro system from Iveco.*

VB-ASCU SOFTWARE + REMOTE BELONGING TO KIT: 1050105602

Description	Remote	Targetgroup	Partnumber	Price
Tip-follow, high-low, extra time-module, off-road, carpark, tilt to left, ferry ramp,	4C camper	motorhome	-	€ -
VB-AutoLevel, hydraulics jacks + air tank (software included in kit)				

OPTIONS BELONGING TO KIT: 1050105602

Description	Fitting time	Partnumber	Price
Emergency inflation valves 4C	1	1052250510	€ 120,00
VB-AutoLevel	0,50	1052200401	€ 485,00

CALIBRATION TOOLS BELONGING TO KIT: 1050105602

Description	Axle	X-Value	Partnumber	Price
Calibration support	front	55mm	0090000032	€ 30,00
Calibration support	rear	130mm	0090000014	€ 30,00



VB-ACTIVEAIR 4C - 60C-70C 2006-CURRENT - FRONT AND REAR AXLE - CAMPING CAR

Kit	Axle	Remark	Fitting time	Partnumber	Price
VB-ActiveAir 4C 60C-70C 2006-current	front and rear	camping car	18	2050105463*	€ 14.530,00

**This solution is only available for campers with a flat floor and raised cabin.*

VB-ASCU SOFTWARE + REMOTE BELONGING TO KIT: 2050105461

Description	Remote	Targetgroup	Partnumber	Price
Tip-follow, high-low, V-signal, carpark, tilt to left, ferry ramp, garage acces, VB-AutoLevel, hydraulics jacks + air tank (software included in kit)	4C camper	motorhome	0080105752	€ -

OPTIONS BELONGING TO KIT: 2050105461

Description	Fitting time	Partnumber	Price
Emergency inflation valves 4C	1	1052250510	€ 120,00

CALIBRATION TOOLS BELONGING TO KIT: 2050105461

Description	Axle	X-Value	Partnumber	Price
VB-AA shock absorber mounting tool	front and rear	-	0090000113	€ 67,50

OPTIONS BELONGING TO KIT: 2050105461

Description	Fitting time	Partnumber	Price
When the vehicle has the option electric handbrake order the extension kit.	-	1052350226	€ 56,50

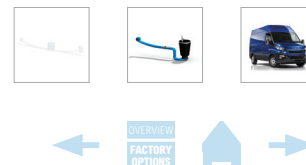

VB-FULLAIR 2C EXTENSION KIT FRONT + VB-ACTIVEAIR EXTENSION KIT - 60C-70C 2013-CURRENT - FRONT AND REAR AXLE - CAMPING CAR

If the VB-ID number from the VB-FullAir \leq 20xxxx-xxxxx-xxx

Kit	Axle	Remark	Fitting time	Partnumber	Price
VB-FullAir 2C Extension kit front + VB-ActiveAir Extension 60C-70C 2013-current	front and rear	camping car	11	2050105512*	€ 9.610,00

If the VB-ID number from the VB-FullAir \geq 21xxxx-xxxxx-xxx - 245271-xxxxx-xx

Kit	Axle	Remark	Fitting time	Partnumber	Price
VB-FullAir 2C Extension kit front + VB-ActiveAir Extension 60C-70C 2013-current	front and rear	camping car	11	2050105511*	€ 9.795,00

If the VB-ID number from the VB-FullAir \geq 245271-xxxxx-xxx

Kit	Axle	Remark	Fitting time	Partnumber	Price
VB-FullAir 2C Extension kit front + VB-ActiveAir Extension 60C-70C 2013-current	front and rear	camping car	11	2050105514*	€ 9.495,00

*This solution is only available for campers with a flat floor, raised cabin and VB-FullAir 2C.

VB-ASCU SOFTWARE + REMOTE BELONGING TO KIT: 2050105511, 2050105512 & 2050105514

Description	Remote	Targetgroup	Partnumber	Price
Tip-follow, high-low, V-signal, carpark, tilt to left, ferry ramp, garage acces, VB-AutoLevel, hydraulics jacks + air tank (software included in kit)	4C camper	motorhome	0080105752	€ -

OPTIONS BELONGING TO KIT: 2050105511, 2050105512 & 2050105514

Description	Fitting time	Partnumber	Price
Emergency inflation valves 4C	1	1052250510	€ 120,00
VB-AutoLevel	0,50	1052200401	€ 485,00

CALIBRATION TOOLS BELONGING TO KIT: 2050105511, 2050105512 & 2050105514

Description	Axle	X-Value	Partnumber	Price
VB-AA shock absorber mounting tool	front and rear	-	0090000113	€ 67,50

CALIBRATION TOOLS BELONGING TO KIT: 2050105511, 2050105512 & 2050105514

Description	Axle	X-Value	Partnumber	Price
Calibration support	front	55mm	0090000032	€ 30,00
Calibration support	rear	130mm	0090000014	€ 30,00



VB-ACTIVEAIR EXTENSION KIT - 60C-70C 2013-CURRENT - FRONT AND REAR AXLE - CAMPING CAR

If the VB-ID number from the VB-FullAir ≤ 20xxxx-xxxxx-xxx

Kit	Axle	Remark	Fitting time	Partnumber	Price
VB-ActiveAir Extension 60C-70C 2013-current	front and rear	camping car	7	2050105513*	€ 6.750,00

If the VB-ID number from the VB-FullAir ≥ 21xxxx-xxxxx-xxx

Kit	Axle	Remark	Fitting time	Partnumber	Price
VB-ActiveAir Extension 60C-70C 2013-current	front and rear	camping car	7	2050105510*	€ 6.620,00

If the VB-ID number from the VB-FullAir ≥ 245271-xxxxx-xxx

Kit	Axle	Remark	Fitting time	Partnumber	Price
VB-FullAir 2C Extension kit front + VB-ActiveAir Extension 60C-70C 2013-current	front and rear	camping car	7	2050105515*	€ 5.995,00

**This solution is only available for campers with a flat floor, raised cabin and VB-FullAir 4C.*

VB-ASCU SOFTWARE + REMOTE BELONGING TO KIT: 2050105510, 2050105513 & 2050105515

Description	Remote	Targetgroup	Partnumber	Price
Tip-follow, high-low, V-signal, carpark, tilt to left, ferry ramp, garage acces, VB-AutoLevel, hydraulics jacks + air tank (software included in kit)	4C camper	motorhome	0080105752	€ -

OPTIONS BELONGING TO KIT: 2050105510, 2050105513 & 2050105515

Description	Fitting time	Partnumber	Price
Emergency inflation valves 4C	1	1052250510	€ 120,00

CALIBRATION TOOLS BELONGING TO KIT: 2050105510, 2050105513 & 2050105515

Description	Axle	X-Value	Partnumber	Price
VB-AA shock absorber mounting tool	front and rear	-	0090000113	€ 67,50



- + MERCEDES-BENZ AL-KO AMC
- + SPRINTER VS30
- + 2018-CURRENT

Latest price update: 01-11-2024

VB-SEMAIR

VB-FULLAIR 2C AL-KO AMC 4XX 4X2 - REAR AXLE

VB-FULLAIR 2C AL-KO AMC 5XX 6X2 - REAR AXLE

VB-FULLAIR 4C AL-KO AMC 4XX 4X2 - FRONT AND REAR AXLE

VB-FULLAIR 4C AL-KO AMC 5XX 6X2 - FRONT AND REAR AXLE

VB-FULLAIR 2C - EXTENSION KIT

V 00

V 07

V 07

V 04

V 04

V 03



VB-SEMIAIR

Kit	Axle	Remark	Fitting time	Partnumber	Price
VB-SemiAir VS30 FWD AL-KO AMC 4x2	rear	comfort-camper LH console single axle	4	VBSA-AMCVS30-01C-L*	€ 1.830,00
VB-SemiAir VS30 FWD AL-KO AMC 4x2	rear	comfort-camper RH console single axle	4	VBSA-AMCVS30-01C-R*	€ 1.830,00
VB-SemiAir VS30 FWD AL-KO AMC 6x2	rear	comfort-camper LH console twin axle	5	VBSA-AMCVS30-02C-L*	€ 2.720,00
VB-SemiAir VS30 FWD AL-KO AMC 6x2	rear	comfort-camper RH console twin axle	5	VBSA-AMCVS30-02C-R*	€ 2.720,00

***Kits VBSA-AMCVS30-01C-L/R and VBSA-AMCVS30-02C-L/R will not fit on vehicles equipped with Mercedes-Benz factory option code T55+(G42/G43/M1E)+(ZU8/ZU7).**

 ***See bulletin VBA-GB2022-001-EN for the differences between left (L) and right (R) of the SemiAir comfort-camper kits.**

Kit only fits on a wide-track (1980mm), the kit doesn't fit on a normal-track (1890mm).

Kit doesn't fit on the 3,5T and 3,55T variants.



VB-FULLAIR 2C AL-KO AMC 4XX 4X2 - REAR AXLE

Kit	Axle	Remark	Fitting time	Partnumber	Price
VB-FullAir 2C AL-KO AMC	rear	-	8	1050227253	€ 5.320,00

See our Suspension-Portal for the AL-KO search-machine to choose the right kit and the attachment VBA-SB2022-003 in the annex.

Kit only fits on a wide-track (1980mm), the kit doesn't fit on a normal-track (1890mm).

Kit doesn't fit on the 3,5T and 3,55T variants.

VB-ASCU SOFTWARE + REMOTE BELONGING TO KIT: 1050227253

Description	Remote	Targetgroup	Partnumber	Price
Tip-follow, speed signal	2C standard	-	0080227281	
Tip-follow, speed signal, hydraulic jacks	2C camper	motorhome	0080227287	€ -

OPTIONS BELONGING TO KIT: 1050227253

Description	Fitting time	Partnumber	Price
Extra rear-door switch	0,50	1052201092	€ 50,00
Emergency inflation valves	1	1052250513	€ 90,00
Can-bus interface for the Sprinter VS30 if not equipped with factory option EK1 or ED5. If equipped with ED5 it must have the speedsignal programmed (not discountable).	0,25	1052201253	€ 225,00

 Refer to VBA-SB2022-002 to see if a Can-bus interface is needed.

CALIBRATION TOOLS BELONGING TO KIT: 1050227253

Description	axle	X-Value	Partnumber	Price
Calibration support kit	rear	N/A	0090060031	€ 30,00

REMARKS REGARDING FACTORY OPTIONS, FOR KIT: 1050227253

Description	Fitting time	Partnumber	Price
Modification kit for the air tank. If the vehicle is equipped with hydraulic jacks and the air tank has to be relocated.		1052351148	€ 90,00

REMARKS REGARDING FACTORY OPTIONS, FOR KIT: 1050227253

When ordering a VB-FullAir kit always order factory option "EK1" and "ED5".

Note for speed signal software: The vehicle needs to be programmed by the Mercedes-Benz dealer with a speed signal in a square wave 1Hz=1km/h.



VB-FULLAIR 2C AL-KO AMC 5XX 6X2 - REAR AXLE

Kit	Axle	Remark	Fitting time	Partnumber	Price
VB-FullAir 2C AL-KO AMC	rear		12	1050227254	€ 8.515,00

See our Suspension-Portal for the AL-KO search-machine to choose the right kit and the attachment VBA-SB2022-003 in the annex.

VB-ASCU SOFTWARE + REMOTE BELONGING TO KIT: 1050227254

Description	Remote	Targetgroup	Partnumber	Price
Tip-follow, speed signal	2C standard	-	0080227291	
Tip-follow, speed signal, hydraulic jacks	2C camper	motorhome	0080227297	€ -

OPTIONS BELONGING TO KIT: 1050227254

Description	Fitting time	Partnumber	Price
Extra rear-door switch	0,50	1052201092	€ 50,00
Emergency inflation valves	1	1052250513	€ 90,00
Can-bus interface for the Sprinter VS30 if not equipped with factory option EK1 or ED5. If equipped with ED5 it must have the speedsignal programmed (not discountable).	0,25	1052201253	€ 225,00

 Refer to VBA-SB2022-002 to see if a Can-bus interface is needed.

CALIBRATION TOOLS BELONGING TO KIT: 1050227254

Description	axle	X-Value	Partnumber	Price
Calibration support kit	rear	N/A	0090060031	€ 30,00

REMARKS REGARDING FACTORY OPTIONS, FOR KIT: 1050227254

Description	Fitting time	Partnumber	Price
Modification kit for the air tank. If the vehicle is equipped with hydraulic jacks and the air tank has to be relocated.		1052351148	€ 90,00

REMARKS REGARDING FACTORY OPTIONS, FOR KIT: 1050227254

When ordering a VB-FullAir kit always order factory option "EK1" and "ED5".

Note for speed signal software: The vehicle needs to be programmed by the Mercedes-Benz dealer with a speed signal in a square wave 1Hz=1km/h.



VB-FULLAIR 4C AL-KO AMC 4XX 4X2 - FRONT AND REAR AXLE

Kit	Axle	Remark	Fitting time	Partnumber	Price
VB-FullAir 4C AL-KO AMC	front & rear	-	12-13	1050227453	€ 8.995,00

See our Suspension-Portal for the AL-KO search-machine to choose the right kit and the attachment VBA-SB2022-003 in the annex.

Kit only fits on a wide-track (1980mm), the kit doesn't fit on a normal-track (1890mm).

Kit doesn't fit on the 3,5T and 3,55T variants.

Kit only available for vehicles with a maximum front axle weight 2100 kg.

For mounting the front struts you need special Mercedes-Benz tools. Article numbers for these OEM MB tools are 907589000900 and 177589003100 or aftermarket tools can be used. These are not included in the kit and cannot be ordered by VBA.

VB-ASCU SOFTWARE + REMOTE BELONGING TO KIT: 1050227453

Description	Remote	Targetgroup	Partnumber	Price
Tip-follow, speed signal, carpark, tilt, ferry ramp, garage access, VB-Autolevel, hydraulic jacks	4C camper	motorhome	0080227487	€ -

OPTIONS BELONGING TO KIT: 1050227453

Description	Fitting time	Partnumber	Price
Extra rear-door switch	0,50	1052201092	€ 50,00
Emergency inflation valves	1	1052250514	€ 120,00
VB-AutoLevel	0,50	1052200401	€ 485,00
Can-bus interface for the Sprinter VS30 if not equipped with factory option EK1 or ED5. If equipped with ED5 it must have the speedsignal programmed (not discountable).	0,25	1052201253	€ 225,00

 Refer to VBA-SB2022-002 to see if a Can-bus interface is needed.

CALIBRATION TOOLS BELONGING TO KIT: 1050227453

Description	axle	X-Value	Partnumber	Price
Calibration support kit	rear	N/A	0090060031	€ 30,00

*There are no calibration supports available for the front strut.

REMARKS REGARDING FACTORY OPTIONS, FOR KIT: 1050227453

Description	Fitting time	Partnumber	Price
Modification kit for the air tank. If the vehicle is equipped with hydraulic jacks and the air tank has to be relocated.		1052351148	€ 90,00

REMARKS REGARDING FACTORY OPTIONS, FOR KIT: 1050227453

When ordering a VB-FullAir kit always order factory option "EK1" and "ED5".

Note for speed signal software: The vehicle needs to be programmed by the Mercedes-Benz dealer with a speed signal in a square wave 1Hz=1km/h.



VB-FULLAIR 4C AL-KO AMC 5XX 6X2 - FRONT AND REAR AXLE

Kit	Axle	Remark	Fitting time	Partnumber	Price
VB-FullAir 4C AL-KO AMC	front & rear		16-17	1050227454	€ 12.190,00

See our Suspension-Portal for the AL-KO search-machine to choose the right kit and the attachment VBA-SB2022-003 in the annex.

Kit only available for vehicles with a maximum front axle weight 2100 kg.

For mounting the front struts you need special Mercedes-Benz tools. Article numbers for these OEM MB tools are 907589000900 and 177589003100 or aftermarket tools can be used. These are not included in the kit and cannot be ordered by VBA.

VB-ASCU SOFTWARE + REMOTE BELONGING TO KIT: 1050227454

Description	Remote	Targetgroup	Partnumber	Price
Tip-follow, speed signal, carpark, tilt, ferry ramp, garage access, VB-Autolevel, hydraulic jacks	4C camper	motorhome	0080227497	€ -

OPTIONS BELONGING TO KIT: 1050227454

Description	Fitting time	Partnumber	Price
Extra rear-door switch	0,50	1052201092	€ 50,00
Emergency inflation valves	1	1052250514	€ 120,00
VB-AutoLevel	0,50	1052200401	€ 485,00
Can-bus interface for the Sprinter VS30 if not equipped with factory option EK1 or ED5. If equipped with ED5 it must have the speedsignal programmed (not discountable).	0,25	1052201253	€ 225,00

CALIBRATION TOOLS BELONGING TO KIT: 1050227454

Description	axle	X-Value	Partnumber	Price
Calibration support kit	rear	N/A	0090060031	€ 30,00

*There are no calibration supports available for the front strut.

REMARKS REGARDING FACTORY OPTIONS, FOR KIT: 1050227454

Description	Fitting time	Partnumber	Price
Modification kit for the air tank. If the vehicle is equipped with hydraulic jacks and the air tank has to be relocated.		1052351148	€ 90,00

REMARKS REGARDING FACTORY OPTIONS, FOR KIT: 1050227454

When ordering a VB-FullAir kit always order factory option "EK1" and "ED5".

Note for speed signal software: The vehicle needs to be programmed by the Mercedes-Benz dealer with a speed signal in a square wave 1Hz=1km/h.



VB-FULLAIR 2C - EXTENSION KIT

Kit	Axle	Remark	Fitting time	Partnumber	Price
VB-FullAir 2C Rear > 4C - Extension kit	front	front axle extension with camper remote	4-5	1050227600	€ 3.995,00

Kit only available for vehicles with a maximum front axle weight 2100 kg.

For mounting the front struts you need special Mercedes-Benz tools. Article numbers for these OEM MB tools are 907589000900 and 177589003100 or aftermarket tools can be used. These are not included in the kit and cannot be ordered by VBA.

VB-ASCU SOFTWARE + REMOTE BELONGING TO KIT: 1050227600

Description	Remote	Targetgroup	Partnumber	Price
Tip-follow, speed signal, carpark, tilt, ferry ramp, garage access, VB-Autolevel, hydraulic jacks	4C camper (4x2)	motorhome	0080227487	€ -
Tip-follow, speed signal, carpark, tilt, ferry ramp, garage access, VB-Autolevel, hydraulic jacks	4C camper (6x2)	motorhome	0080227497	€ -

OPTIONS BELONGING TO KIT:

Emergency inflation valves	1	1052250514	€ 120,00
VB-AutoLevel	0,50	1052200401	€ 485,00

REMARKS REGARDING FACTORY OPTIONS, FOR KIT: 1050227600

Description	Fitting time	Partnumber	Price
Modification kit for the air tank. If the vehicle is equipped with hydraulic jacks and the air tank has to be relocated.		1052351148	€ 90,00

REMARKS REGARDING FACTORY OPTIONS, FOR KIT: 1050227600

When ordering a VB-FullAir kit always order factory option "EK1" and "ED5".

Note for speed signal software: The vehicle needs to be programmed by the Mercedes-Benz dealer with a speed signal in a square wave 1Hz=1km/h.



- + MERCEDES-BENZ
- + SPRINTER VS30
- + 2018-CURRENT

Latest price update: 01-11-2024

VB-COILSPRING

V 00

VB-SEMIAIR

V 02

VB-FULLAIR 2C 2XX-3XX-4XX FWD - REAR AXLE

V 01

VB-FULLAIR 2C 2XX-3XX-4XX RWD - REAR AXLE

V 01

VB-FULLAIR 2C 2XX-3XX-4XX - REAR AXLE - 4X4

V 03

VB-FULLAIR 2C 5XX - REAR AXLE

V 01

VB-FULLAIR 2C 5XX - REAR AXLE - LEVEL +25MM

V 01

VB-FULLAIR 2C 5XX - 4X4

V 01

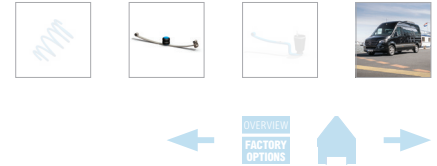

VB-SEMIAIR

Kit	Axle	Remark	Fitting time	Partnumber	Price
VB-SemiAir 2XX-3XX FWD	rear	base	3	1550227200	€ 567,50
VB-SemiAir 2XX-3XX FWD	rear	comfort-LCV	4-5	VBSA-MBS-FWD-01B	€ 937,50
VB-SemiAir 2XX-3XX FWD	rear	comfort-camper	4-5	VBSA-MBS-FWD-01C-L*	€ 1.025,00
VB-SemiAir 2XX-3XX FWD	rear	comfort-camper	4-5	VBSA-MBS-FWD-01C-R*	€ 1.025,00

Kit	Axle	Remark	Fitting time	Partnumber	Price
VB-SemiAir 2XX-3XX-4XX RWD	rear	base	3	1550220101*	€ 567,50
VB-SemiAir 2XX-3XX-4XX RWD	rear	comfort-LCV	4-5	VBSA-MBS-35-03B*	€ 937,50
VB-SemiAir 2XX-3XX-4XX RWD	rear	comfort-camper	4-5	VBSA-MBS-35-03C-L*	€ 1.025,00
VB-SemiAir 2XX-3XX-4XX RWD	rear	comfort-camper	4-5	VBSA-MBS-35-03C-R*	€ 1.025,00

***Kits 1550220101, VBSA-MBS-35-03B and VBSA-MBS-35-03C-L/R are only available in combination with MB factory option code CW2. If the vehicle is not equipped with option code CW2, the vehicle has a lowered chassis and therefore kit 1550220101, VBSA-MBS-35-03B and VBSA-MBS-35-03C-L/R can not be installed.**

If the vehicle is equipped with factory option code CE8 the kit will fit.

Please note: In some country's the vehicle has standard a lowered chassis.

***Kits 1550220101, VBSA-MBS-35-03B and VBSA-MBS-35-03C-L/R are not available for Mercedes-Benz Sprinter 2XX-3XX with factory code C33 and C83.**

***Kits VBSA-MBS-FWD-01C-L/R and VBSA-MBS-35-03C-L/R, will not fit on vehicles equipped with factory option code T55+(G42/G43/M1E)+(ZU8/ZU7).**

***See bulletin VBA-GB2022-001-EN for the differences between left (L) and right (R) of the SemiAir comfort-camper kits.**

Kit	Axle	Remark	Fitting time	Partnumber	Price
VB-SemiAir 2XX-3XX-4XX 4x4	rear	base	3	1550227251	€ 670,00
VB-SemiAir 2XX-3XX-4XX 4x4	rear	comfort-LCV	4-5	VBSA-MBS-35-04B	€ 1.025,00
VB-SemiAir 2XX-3XX-4XX 4x4	rear	comfort-camper	4-5	VBSA-MBS-35-04C-L*	€ 1.127,50
VB-SemiAir 2XX-3XX-4XX 4x4	rear	comfort-camper	4-5	VBSA-MBS-35-04C-R*	€ 1.127,50

***Kits VBSA-MBS-35-04C-L/R, will not fit on vehicles equipped with factory option code T55+(G42/G43/M1E)+(ZU8/ZU7).**

ATTENTION MANDATORY PART FOR 1550220101, 1550227251, VBSA-MBS-35-03B, VBSA-MBS-35-04B, VBSA-MBS-35-03C-L/R & VBSA-MBS-35-04C-L/R

Description	Fitting time	Partnumber	Price
Sprinter 2XX-3XX-4XX chassis reinforcement (not discountable) for ALL VAN's with WB 3665 and 4325	0,50	1552350016	€ 135,00

Kit	Axle	Remark	Fitting time	Partnumber	Price
VB-SemiAir 5XX DRW + Supersingle	rear	base	3	1550221100	€ 567,50
VB-SemiAir 5XX DRW + Supersingle	rear	comfort-LCV	4-5	VBSA-MBS-50-01B	€ 937,50
VB-SemiAir 5XX DRW + Supersingle	rear	comfort-camper	4-5	VBSA-MBS-50-03C-L*	€ 1.025,00
VB-SemiAir 5XX DRW + Supersingle	rear	comfort-camper	4-5	VBSA-MBS-50-03C-R*	€ 1.025,00

***Kits 1550221100, VBSA-MBS-50-01B and VBSA-MBS-50-03C-L/R are not available for Mercedes-Benz Sprinter 5XX with factory code C15, C17, C33 and C83.**

***Kits VBSA-MBS-50-03C-L/R will not fit on vehicles equipped with factory option code T55+(G42/G43/M1E)+(ZU8/ZU7).**

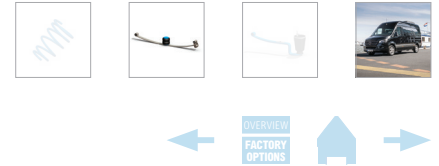

Kit	Axle	Remark	Fitting time	Partnumber	Price
VB-SemiAir 5XX DRW 4x4	rear	base	3	1550228250	€ 670,00
VB-SemiAir 5XX DRW 4x4	rear	comfort-LCV	4-5	VBSA-MBS-50-02B	€ 1.025,00
VB-SemiAir 5XX DRW 4x4	rear	comfort-camper	4-5	VBSA-MBS-50-02C-L*	€ 1.127,50
VB-SemiAir 5XX DRW 4x4	rear	comfort-camper	4-5	VBSA-MBS-50-02C-R*	€ 1.127,50

*Kits VBSA-MBS-50-02C-L/R will not fit on vehicles equipped with factory option code T55+(G42/G43/M1E)+(ZU8/ZU7).

OPTIONS BELONGING TO KIT:

1550227200, VBSA-MBS-FWD-01B, VBSA-MBS-FWD-01C-L/R

Description	Fitting time	Partnumber	Price
LED Modification Kit for Sprinter FWD (not discountable) if the vehicle has LED Lights (MB Option LG7)	0,25	1552350035	€ 25,00

OPTIONS BELONGING TO KIT:

1550227200, 1550220101 & 1550227251

Description	Fitting time	Partnumber	Price
VB-SA Single manometer kit	0,50	1505370049	€ 47,50
VB-SA Dual manometer kit	0,50	1505370050	€ 87,50
Extension for base kit to comfort kit LCV.	1-2	1555370215	€ 497,50
Extension for base kit to VB-LevelAir kit universal	3	1565370228	€ 1.212,50
Extension kit right hand console	1-2	1555370234*	€ 665,00
Extension kit left hand console	1-2	1555370235*	€ 665,00

*Extension kits 1555370234 and 1555370235 will not fit on vehicles equipped with factory option code T55+(G42/G43/M1E)+(ZU8/ZU7).

OPTIONS BELONGING TO KIT:

1550221100, VBSA-MBS-50-01B, VBSA-MBS-50-03C-L/R

Description	Fitting time	Partnumber	Price
LED Modification Kit for Sprinter 5XX (not discountable) if the vehicle has LED Lights (MB Option LG7)	0,25	1552350034	€ 25,00

OPTIONS BELONGING TO KIT:

1550228250, VBSA-MBS-50-02B, VBSA-MBS-50-02C-L/R

Description	Fitting time	Partnumber	Price
LED Modification Kit for Sprinter 5XX (not discountable) if the vehicle has LED Lights (MB Option LG7)	0,25	1552350036	€ 35,00

OPTIONS BELONGING TO KIT:

1550221100 & 1550228250

Description	Fitting time	Partnumber	Price
VB-SA Single manometer kit	0,50	1505370049	€ 47,50
VB-SA Dual manometer kit	0,50	1505370050	€ 87,50
Extension for base kit to comfort kit LCV.	1-2	1555370208	€ 497,50
Extension for base kit to VB-LevelAir kit universal	3	1565370228	€ 1.212,50
Extension kit right hand console	1-2	1555370234*	€ 665,00
Extension kit left hand console	1-2	1555370235*	€ 665,00

*Extension kits 1555370234 and 1555370235 will not fit on vehicles equipped with factory option code T55+(G42/G43/M1E)+(ZU8/ZU7).



- + OPEL
- + MOVANO X290
- + 2022-CURRENT

Latest price update: 01-11-2024

VB-SPECIALPARTS

V 00

VB-COILSPRING

V 00

VB-SEMIAIR

V 05

VB-FULLAIR 2C - FRONT AXLE

V 01

VB-FULLAIR 2C - REAR AXLE

V 02

VB-FULLAIR 2C - MODIFICATION SET

V 00

VB-FULLAIR 4C - FRONT AND REAR AXLE

V 02

VB-FULLAIR 2C - EXTENSION KIT

V 02



VB-SEMIAIR

Kit	Axle	Remark	Fitting time	Partnumber	Price
VB-SemiAir	rear	base	3-4	1550307100	€ 497,50
VB-SemiAir	rear	comfort-LCV	4-5	VBSA-X250-01B	€ 882,50
VB-SemiAir	rear	comfort-LCV RHD	4-5	VBSA-X250-01BUK	€ 882,50
VB-SemiAir	rear	comfort-camper	4-5	VBSA-X250-01C	€ 882,50
VB-SemiAir	rear	comfort-camper RHD	4-5	VBSA-X250-01CUK	€ 882,50
VB-SemiAir	rear	comfort-camper LHD (EPB)	4-5	VBSA-X250-02C*	€ 882,50
VB-SemiAir	rear	comfort-digital	4	VBSA-X250-03	€ 995,00

ATTENTION MANDATORY PART

Description

If the PFCO X290 is equipped with factory option code 062 (stabilizer bar) and factory option code 026 (electric parking brake), the modification stabilizer bar

1552350047 needs to be ordered. The kit fits on a normal track and wide track.

* **VBSA-X250-02C will not fit RHD (Right Hand Drive) vehicles.**

Description	Fitting time	Partnumber	Price
Modification stabiliser bar (not discountable)	2	1552350047	€ 100,00

When the vehicle is equipped with heated seats or an air-suspended driver's seat, the comfort-LCV kit does not fit.

When the vehicle is equipped with a parking heater or electric parking brake (option 026), the comfort-camper kit VBSA-X250-01C(UK) does not fit.

OPTIONS BELONGING TO KIT:

1550307100

Description	Fitting time	Partnumber	Price
VB-SA Single manometer kit	0,50	1505370049	€ 47,50
VB-SA Dual manometer kit	0,50	1505370050	€ 87,50
VB-CK2 Universal compressor kit	1	1555370102	€ 410,00
Extension for base kit to comfort kit universal	2	1555370218	€ 497,50
Extension for base kit to comfort kit universal DIN slot	2	1555370217	€ 497,50
Extension for base kit to comfort kit LCV	1-2	1555370202	€ 497,50
Extension for base kit to comfort kit LCV RHD	1-2	1555370203	€ 497,50
Extension for base kit to comfort kit camper	1-2	1555370200	€ 497,50
Extension for base kit to comfort kit camper RHD	1-2	1555370201	€ 497,50
Extension for base kit to comfort kit camper LHD (EPB)	1-2	1555370238	€ 497,50
Extension for base kit to comfort kit digital	1	1555370243	€ 617,50
Extension for base kit to VB-LevelAir kit universal	3	1565370228	€ 1.212,50



- + PEUGEOT
- + BOXER X250/X290
- + 2006-CURRENT

Latest price update: 01-11-2024

VB-SPECIALPARTS

V 00

VB-COILSPRING

V 00

VB-SEMIAIR

V 05

VB-FULLAIR 2C - FRONT AXLE

V 01

VB-FULLAIR 2C - REAR AXLE

V 02

VB-FULLAIR 2C - MODIFICATION SET

V 00

VB-FULLAIR 4C - FRONT AND REAR AXLE

V 02

VB-FULLAIR 2C - EXTENSION KIT

V 02



VB-SEMIAIR

Kit	Axle	Remark	Fitting time	Partnumber	Price
VB-SemiAir	rear	base	3-4	1550307100	€ 497,50
VB-SemiAir	rear	comfort-LCV	4-5	VBSA-X250-01B	€ 882,50
VB-SemiAir	rear	comfort-LCV RHD	4-5	VBSA-X250-01BUK	€ 882,50
VB-SemiAir	rear	comfort-camper	4-5	VBSA-X250-01C	€ 882,50
VB-SemiAir	rear	comfort-camper RHD	4-5	VBSA-X250-01CUK	€ 882,50
VB-SemiAir	rear	comfort-camper LHD (EPB)	4-5	VBSA-X250-02C*	€ 882,50
VB-SemiAir	rear	comfort-digital	4	VBSA-X250-03	€ 995,00

ATTENTION MANDATORY PART

Description

If the PFCO X290 is equipped with factory option code 062 (stabilizer bar) and factory option code 026 (electric parking brake), the modification stabilizer bar 1552350047 needs to be ordered. The kit fits on a normal track and wide track.

* **VBSA-X250-02C will not fit RHD (Right Hand Drive) vehicles.**

Description	Fitting time	Partnumber	Price
Modification stabiliser bar (not discountable)	2	1552350047	€ 100,00

When the vehicle is equipped with heated seats or an air-suspended driver's seat, the comfort-LCV kit does not fit.

When the vehicle is equipped with a parking heater or electric parking brake (option 026), the comfort-camper kit VBSA-X250-01C(UK) does not fit.

OPTIONS BELONGING TO KIT:

1550307100

Description	Fitting time	Partnumber	Price
VB-SA Single manometer kit	0,50	1505370049	€ 47,50
VB-SA Dual manometer kit	0,50	1505370050	€ 87,50
VB-CK2 Universal compressor kit	1	1555370102	€ 410,00
Extension for base kit to comfort kit universal	2	1555370218	€ 497,50
Extension for base kit to comfort kit universal DIN slot	2	1555370217	€ 497,50
Extension for base kit to comfort kit LCV	1-2	1555370202	€ 497,50
Extension for base kit to comfort kit LCV RHD	1-2	1555370203	€ 497,50
Extension for base kit to comfort kit camper	1-2	1555370200	€ 497,50
Extension for base kit to comfort kit camper RHD	1-2	1555370201	€ 497,50
Extension for base kit to comfort kit camper LHD (EPB)	1-2	1555370238	€ 497,50
Extension for base kit to comfort kit digital	1	1555370243	€ 617,50
Extension for base kit to VB-LevelAir kit universal	3	1565370228	€ 1.212,50